



Wood Turners Worldwide

worldwidewoodturners.org and the art of making shavings

Newsletter

FEBRUARY 26, 2025

VOLUME 2 NUMBER 5



Scott Medori



Roger Wollam



Ralph Vawter



Ray Apodaca

Clockwise from top right: Spalted poplar bowl; Open segmented catalpa bowl; White oak bowl and platter; Yellow cedar burl vase with spruce cones in resin.

Worldwide Woodturners meets every Wednesday at 7 PM EST via Zoom! Go to worldwidewoodturners.org and click "Go to meeting." Weekly demonstrations!



Billy Burt



Bambi Golombiski



Craig Strohmer



Norman Calvin

Wood Turners Worldwide

Capt. Eddie Castelin - Founder
 Dane Chandler - Administrator
 David Rhodes - Webmaster
 Joaquin Juatai - Editor

©2025 by worldwidewoodturners.org this work is openly licensed by CC BY-NC-ND. For more information visit creativecommons.org/licenses/by-nc-nd/4.0/





Jon Moore



Al Dawson



Heather Budarick

Your art belongs in our newsletter! Email hi-res images to editor@worldwidewoodturners.org. Include a brief description and make sure you identify yourself so I can give you credit!

Facing page, clockwise from top left: Cedar elm and live oak birdhouse dyed using Mathias Beer's method as demonstrated to the club; Poplar gnome with cherry mushrooms; Box elder bowl; Vessel made of an unknown pallet wood. **This page, top left:** Maple bowl with gold leaf embellishment; **Bottom left:** Basket weave illusion plate; **Right:** Emerging vase.



Using a steady rest while turning large, flat pieces

By Howard King

Most times turning a flat piece to a very thin thickness (less than a quarter of an inch or 6 mm) such as a disc or platter is not much of a problem, especially if it is a small diameter around a foot (30 cm) or less. One simple method: if the wood starts to flex while turning, one can place and hold the piece with their finger(s) to the back side while slicing across the face with a bowl gouge with the right hand. Holding a crumpled piece of paper towel or wearing a glove will help to keep from burning your finger(s) while you do this technique. [Editor's note: a folded white 3m pad is much safer than a glove for this.] This takes a lot of practice and concentration, and is quite daunting for an inexperienced wood turner. When turning much larger pieces thin, it becomes quite worrisome; especially for me. Having the task of reducing the thickness of a 23 inch diameter piece of mahogany to less than one-fourth inch thickness, I devised a way to use a steady rest to help reduce flexion while thinning. I had a homemade steady rest that I removed the arms from, then clamped at a 90 degree angle to the steady rest frame. Each of the arms were placed and secured so that the wheels on the arms would gently touch the back of mahogany, thus, helping in the back and forth movement or flexing of the piece as I turned it thinner. This successfully resulted in a consistent and even thickness of this large piece, as I was able to turn it down to five-sixteenths (or 5 mm) of an inch.





Jim and Rita Duxbury demonstrated how to turn and embellish this multi-axis bowl using the Dux Chuck during our February 12th meeting. Video of the of the demonstration alone, or of the full meeting can be found on our YouTube channel, @worldwidewoodturners1.

Worldwide Woodturners meets every Wednesday at 7 PM EST via Zoom! Go to worldwidewoodturners.org and click "Go to meeting." Weekly demonstrations!



Antonio Carbone



Jeff Walters



Alan Spears

Middle left: Segmented bowl of walnut, rock maple, and veneer inserted between top row segments. **Middle right:** Spalted maple, bloodwood, and epoxy bowl; **Bottom left:** Box elder serving tray turned in the style of Tomislav Tomasic.

Level-up



•3 Full Days of Demonstrations
•4 Complete Turning Pods

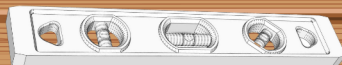

Instructors

Dean Grimes	Jeff Walters
Kade Bolger	Brent Sobotka
Billy Burt	Roger Wollam
Tim Hatch	Dan Smith
Paul Hannaby	Dave Rhodes
Martin Clarkson	Sue Jilek
Gary Hales	Jim Duxbury
Matt Harber	Rita Duxury
Joaquin Juatai	

September 17-20 2026
Wisconsin Rapids Wisconsin

Tuition Cost \$160

Includes all training &
Evening Meal

Hotel Accomodations are now available.

Tools

Gallery

Friends

levelup@worldwidewoodturners.org

More details to come!!!



Level Up: Off Lathe Brent Sobotka

Brent Sobotka will share his techniques for producing this striking detail through chemical patination and the use of copper & silver leaf. Attendees will learn to produce this striking detail and incorporate metal leaf stencil processing.

Brent will show you how to accomplish this on board stock (provided), a piece of your liking you bring with you, or you can use a piece you made at a different pod session at Level-Up.

